

PROPERTY OWNERSHIP MAP  
PINELLAS COUNTY

JIM SMITH  
PROPERTY APPRAISER

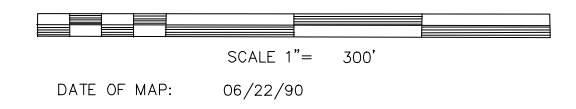

COUNTY LOCATOR

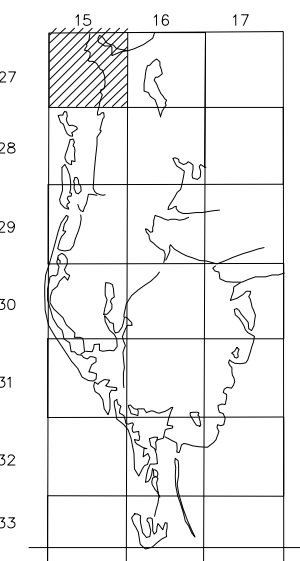

SHEET MATCH

ST	S10-27-15	S11-27-15
JOSEPH	N15-27-15	N14-27-15
SOUND	S15-27-15	S14-27-15

LEGEND

COUNTY LINE	---	AREA (FROM DEED)	10.5 Ac
CITY LIMIT LINE	---	AREA (CALCULATED)	10.5 Ac(0)
TAX DISTRICT LINE	---	DIMENSIONS (FROM DEED)	100.3
ROAD R/W	---	DIMENSIONS (SCALED)	100.00
RAILROAD R/W	---	WATER	
SUB LINE	---	INTERSTATE HIGHWAY	275
PROPERTY LINE	---	U.S. HIGHWAY	19
LAND HOOK	---	STATE HIGHWAY	60
INTERIOR TRACT LINE OR ORIGINAL LOT LINE	---	COUNTY HIGHWAY	1
SUB LOT NUMBERS	31	ROADS OR STREETS	BY NAME
PARCEL NUMBER (W & B)	00/00	MAJOR TRANSMISSION LINES	POWER GAS OR OIL
BLOCK NUMBER	2		
STATE PLANE COORDINATES	375000	SECTION CORNERS	2   1 11   12
CHURCHES, SCHOOLS, CEMETERIES, AIRPORTS, GOVERNMENT LANDS, ETC.	BY NAME	ASSIGNED M & B PINELLAS FARMS/GROVES GEO-LOCATOR (BLK FIELD)	200   100 300   400
SUB NUMBER		OTHER ASSIGNED BLK/LOT DESIGNATOR	(3)

REVISIONS		
DATE	BY	CHANGES OR ADDITIONS
09/00	pc	UPDATE/SP/IT
11/99	KW	UPDATE/MISC CORR
01/00	PC	UPDATE/COMB
08/00	pc	UPDATE/SPLIT & misc
06/96	JD	REDO COORD/REDRAFT SECTION

SECTION N 1/215  
TOWN 27 SOUTH, RANGE 15 EAST  
N15-27-15  
MAP NUMBER

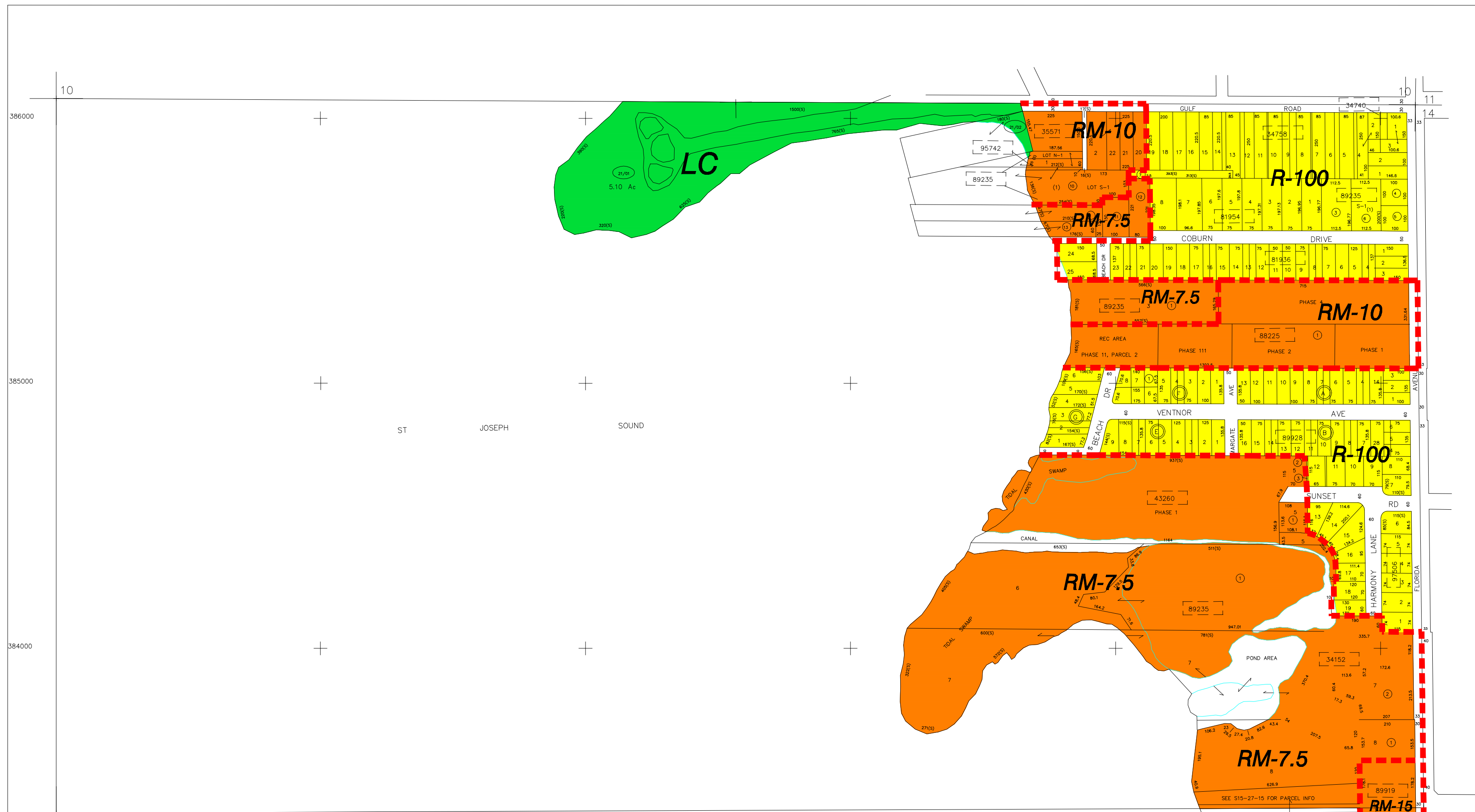

NOTE: SUB # DOES NOT FOLLOW STANDARDIZED PARCEL FORMAT  
LOT FIELD HAS BEEN SHIFTED TO LEFT 1 SPACE  
BLK FIELD HAS BEEN SHIFTED TO LEFT 2 SPACES

GROUP HOME @1629 GULF RD.

NO.	NAME	PB/ PG	NO.	NAME	PB/ PG
35571	HANOVER LANDINGS CONDO	46/090	89919	TARPON POINT CONDO	19/054
34152	GULF FRONT LAGOON CONDO	98/108	89928	TARPON SHORES	19/006
34740	GULF VIEW PARK ADD	06/099	95742	WEDGEFORTH SUB	06/072
34758	GULF VIEW PARK AND WEDGEFORTH SUB	10/002	97506	WIL MAR GULF ACRES	52/097
43260	ISLAND CLUB OF TARPON SPRINGS CONDO (PHASE 1)	76/075			
81936	SILER SHORES	15/034			
81954	SILER SHORES ADD	50/062			
88225	SUNSET SHORES OF TARPON A CONDO, PHASE 1	72/024			
	PHASE 2 & PHASE 3	77/035			
	PHASE 4	87/019			
* 89235	TAMPA & TARPON SPRINGS LAND CO.	HI/116			

Produced by MDT VLS, Copyright (c) 1991, 1992, Pinellas County, FL, Property Appraiser. All Rights reserved.  
ATTENTION: ALTHOUGH THIS MAP FILE REPRESENTS A SIGNIFICANTLY HIGH DEGREE OF ACCURACY AND COMPLETENESS, IT IS NOT GUARANTEED TO BE 100% ACCURATE. THE PROPERTY APPRAISER'S OFFICE DOES NOT WARRANT OR REPRESENT THAT THE DATA SHOWN ON THIS MAP IS CURRENT OR COMPLETE. THE USER OF THIS MAP SHOULD CONSULT A LICENSED PROFESSIONAL LAND SURVEYOR IN ANY MATTER INVOLVING PROPERTY BOUNDARIES OR RIGHTS OF WAY.