

PROPERTY OWNERSHIP MAP  
PINELLAS COUNTY

PAM DUBOV  
PROPERTY APPRAISER

SCALE 1" = 300'

DATE OF MAP: 05/05/90  
PRINT DATE: 31-MAY-2006



COUNTY LOCATOR

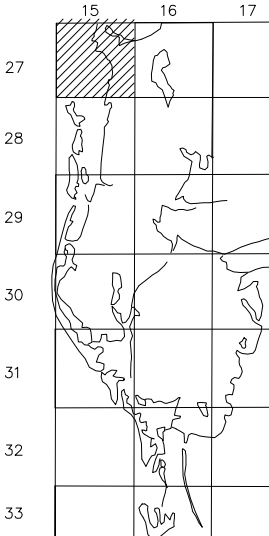

SHEET MATCH

N02-27-15	N01-27-15	N06-27-16
S02-27-15	S01-27-15	S06-27-16
N11-27-15	N12-27-15	N07-27-16

LEGEND

COUNTY LINE	---	AREA (FROM DEED)	10.5 Ac
CITY LIMIT LINE	---	AREA (CALCULATED)	10.5 Ac(c)
TAX DISTRICT LINE	---	DIMENSIONS (FROM DEED)	100.3
ROAD R/W	---	DIMENSIONS (SCALED)	100(3)
RAILROAD R/W	---	WATER	
SUB LINE	---	INTERSTATE HIGHWAY	(275)
PROPERTY LINE	---	U.S. HIGHWAY	(19)
LAND HOOK	---	STATE HIGHWAY	(60)
INTERIOR TRACT LINE OR ORIGINAL LOT LINE	---	COUNTY HIGHWAY	(1)
SUB LOT NUMBERS	31	ROADS OR STREETS	BY NAME
PARCEL NUMBER (M & B)	00/00	MAJOR TRANSMISSION LINES	POWER GAS OR OIL
BLOCK NUMBER	2	SECTION CORNERS	2 1 11 12
STATE PLANE COORDINATES	375000	ASSIGNED M & B	200 100 300 400
CHURCHES, SCHOOLS, GOVERNMENT LANDS ETC.	275000	PINELLAS FARMS/GROVES GEO-LOCATOR (BLK FIELD)	
SUB NUMBER		OTHER ASSIGNED BLK./LOT DESIGNATOR	(3)
SUB PARCEL NO.	1		

REVISIONS

DATE	BY	CHANGES OR ADDITIONS
12/05	TES	UPDATE/COMB
11/05	TES	UPDATE/COMB
01/06	TES	UPDATE/SPLIT NEW SUB
06/02	PC	REDRAFT SECTION
10/96	JD	REDO COORD/EDGEMATCH

SECTION S 1/2 01  
TOWN 27 SOUTH, RANGE 15 EAST  
S01-27-15  
CADASTRAL DEPARTMENT

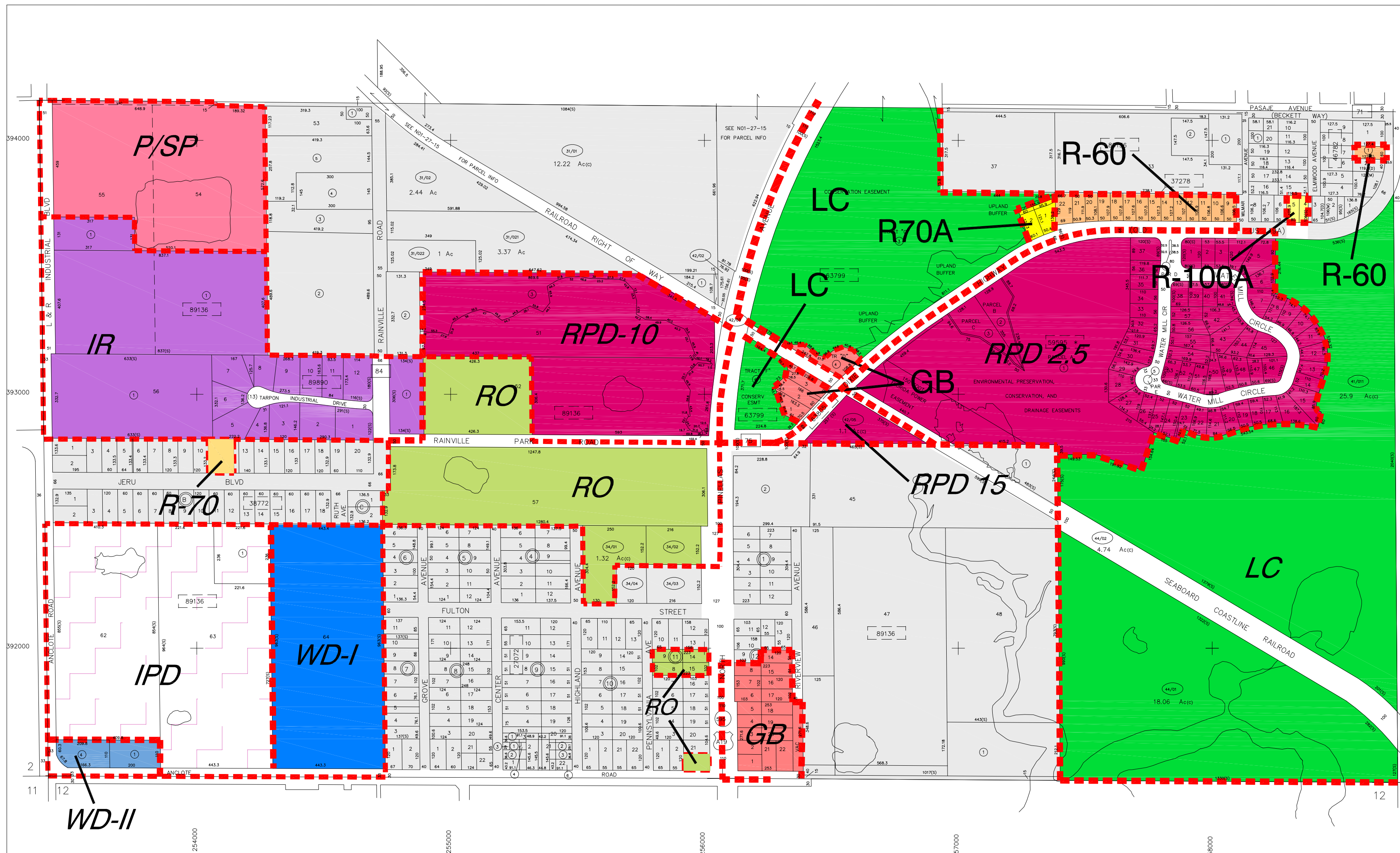

\* SEE PLAT FOR DIMENSIONS  
▲ SEE SPECIAL SETBACKS

NO.	NAME	PB/ PG
27072	FAIRVIEW * BLKS 1-10, TARPON SPRINGS	09/018
37278	HARSHAW HEIGHTS	19/049
38772	HIGHLAND GROVE MANOR	45/008
46782	KING'S ADD TO ALTA VISTA	16/045
▲ 59595	NATURE'S PRESERVE	117/073
63799	OLD DIXIE PARK	124/094
63805	OLD DIXIE PARK SUB TRACT E, LOTS OF	130/100
89136	TAMPA & TARPON SPRINGS LAND CO	HI/116
89890	TARPON INDUSTRIAL CENTER	93/065

Produced by MEDT V2.1, Copyright (c) 1991, Pinellas County, FL, Property Appraiser. All Rights Reserved.  
A WARNING: Although this map file represents a computerized and accurate representation of the information contained herein, it is not intended for use as a substitute for a professional survey. The information on this map file is derived from the public records of Pinellas County, Florida. The information on this map file should not be relied on for any reason as an alternative to a qualified survey. Please consult a licensed professional land surveyor or any other qualified property boundaries or rights of way.