

PROPERTY OWNERSHIP MAP
PINELLAS COUNTY

PAM DUBOV
PROPERTY APPRAISER

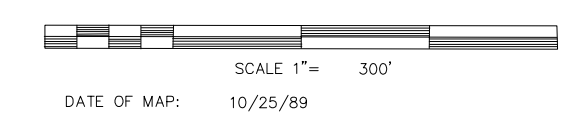

DATE OF MAP: 10/25/89



COUNTY LOCATOR

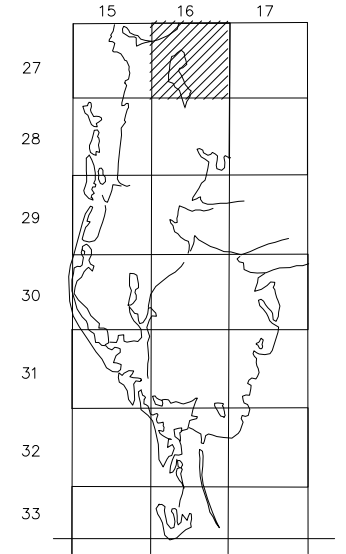

SHEET MATCH

	PASCO COUNTY	
N01-27-15	N06-27-16	N05-27-16
S01-27-15	S06-27-16	S05-27-16

LEGEND

COUNTY LINE	---	AREA (FROM DEED)	10.5 Ac
CITY LIMIT LINE	---	AREA (CALCULATED)	10.5 Ac(c)
TAX DISTRICT LINE	---	DIMENSIONS (FROM DEED)	100.3
ROAD R/W	==	DIMENSIONS (SCALED)	100(3)
RAILROAD R/W	==	WATER	
SUB LINE	---	INTERSTATE HIGHWAY	(275)
PROPERTY LINE	---	U.S. HIGHWAY	(19)
LAND HOOK	---	STATE HIGHWAY	(60)
INTERIOR TRACT LINE OR ORIGINAL LOT LINE	---	COUNTY HIGHWAY	(1)
SUB LOT NUMBERS	31	ROADS OR STREETS	BY NAME
PARCEL NUMBER (W & B)	(06/00)	MAJOR TRANSMISSION LINES	POWER GAS OR OIL
BLOCK NUMBER	(2)	ASSIGNED W & B PINELLAS FARMS/GROVES ETC.	200 100 300 400
STATE PLANE COORDINATES	375000 +	SECTION CORNERS	2 1 11 12
CHURCHES, SCHOOLS, CEMETERIES, AIRPORTS, GOVERNMENT LANDS ETC.	275000	OTHER ASSIGNED BLK./LOT DESIGNATOR	(3)

REVISIONS

DATE	BY	CHANGES OR ADDITIONS
08/01	DS	UPDATE/SPLIT
07/01	TE	MISC CORR
01/01	ENTZ	MISC CORR
01/01	PC	MISC CORR
08/95	JD	REDO COORD/EDGEMATCH
05/05	AM	Cypress Park Sub

SECTION N 1/2 06
TOWN 27 SOUTH, RANGE 16 EAST

N06-27-16
MAP NUMBER

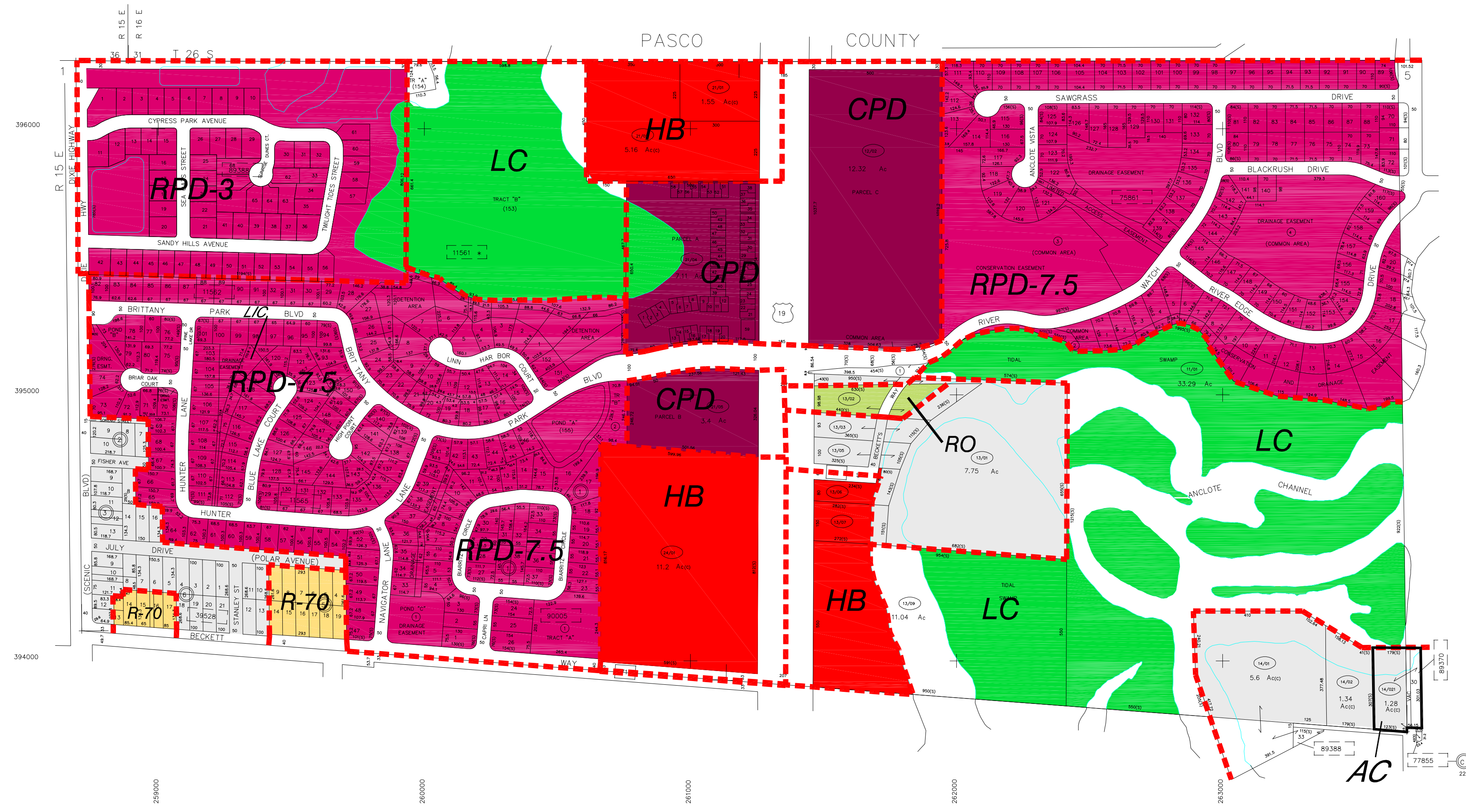

AC: ANNEXATION COVENANT
LIC: LOT 119 BRITTANY PARK PHASE 2, BLUE LAKE CT. REVOCABLE LICENSE TO ENCR OACH

Produced by MDT V2.1, Copyright (c) 1991,1992, Pinellas County, FL Property Appraiser. All Rights Reserved.
ATTENTION: Although this map file represents a showman's best effort of accuracy and completeness, it is intended for use in property assessment. Information on this document may be an advance. No duty of care should be relied on for any reason as an alternative to a qualified survey. Please consult a licensed professional land surveyor in any case involving property boundaries or rights of way.

NO.	NAME	PB/ PG	NO.	NAME	PB/ PG
▲ 11561	BRITTANY PARK PHASE IA	103/017	* 91525	TOWNHOMES AT BRITTANY PARK NORTH CONDO	142/065
▲ 11562	BRITTANY PARK 1B SUBDIVISION	106/074			
▲ 11565	BRITTANY PARK PHASE 2 SUB	110/051			
▲ 20229	CYPRESS PARK OF TARPON SPRINGS	124/085			
* 39528	HIGH POINT PARK	14/067			
▲ 75861	RIVER WATCH	112/079			
77855	SAIL HARBOR (05-27-16)	94/095			
89370	TAMPA AND TARPON SPRINGS LAND CO (05-27-16)	HI/116			
89388	TAMPA AND TARPON SPRINGS LAND CO	HI/116			
90005	TARPON TRACE	112/050			