

PROPERTY OWNERSHIP MAP  
PINELLAS COUNTY

PAM DUBOV  
PROPERTY APPRAISER

SCALE 1" = 300'  
DATE OF MAP: 05/22/90



COUNTY LOCATOR

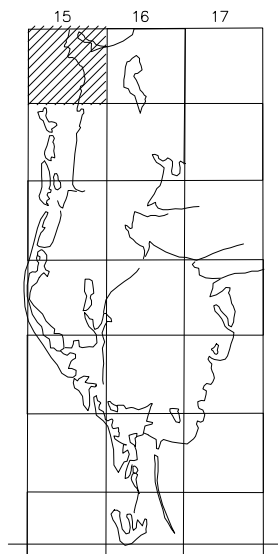

SHEET MATCH

N10-27-15	N11-27-15	N12-27-15
S10-27-15	S11-27-15	S12-27-15
N15-27-15	N14-27-15	N13-27-15

LEGEND

COUNTY LINE	---	AREA (FROM DEED)	10.5 Ac
CITY LIMIT LINE	---	AREA (CALCULATED)	10.5 Ac(c)
TAX DISTRICT LINE	---	DIMENSIONS (FROM DEED)	100.3
ROAD R/W	---	DIMENSIONS (SCALED)	10003
RAILROAD R/W	---	WATER	
SUB LINE	---	INTERSTATE HIGHWAY	75
PROPERTY LINE	---	U.S. HIGHWAY	19
LAND HOOK	---	STATE HIGHWAY	60
INTERIOR TRACT LINE OR ORIGINAL LOT LINE	---	COUNTY HIGHWAY	1
SUB LOT NUMBERS	---	ROADS OR STREETS	BY NAME
PARCEL NUMBER (W & S)	---	MAJOR TRANSMISSION LINES	POWER GAS OR OIL
BLOCK NUMBER	---	SECTION CORNERS	2   1 11   12
STATE PLANE COORDINATES	---	ASSIGNED M & B PINELLAS FARMS/GROVES GEO-LOCATOR (BLK FIELD)	200   100 300   400
CHURCHES, SCHOOLS, CEMETRIES, AIRPORTS, GOVERNMENT LANDS, ETC.	---	OTHER ASSIGNED BLK./LOT DESIGNATOR	(3)
SUB NUMBER	---		
SUB PARCEL NO.	---		

REVISIONS

DATE	BY	CHANGES OR ADDITIONS
12/01	TE	UPDATE/SPLIT/COMB
04/01	PC	UPDATE/SPLIT/COMB
08/01	SAW	UPDATE/SPLIT/MISC
09/01	DS	UPDATE/MISC
12/96	JO	REDO COORD/REDRAFT SECTION
08/05	AM	LICENSE TO ENCROACH

SECTION S 1/2 11  
TOWN 27 SOUTH, RANGE 15 EAST

S11-27-15  
MAP NUMBER

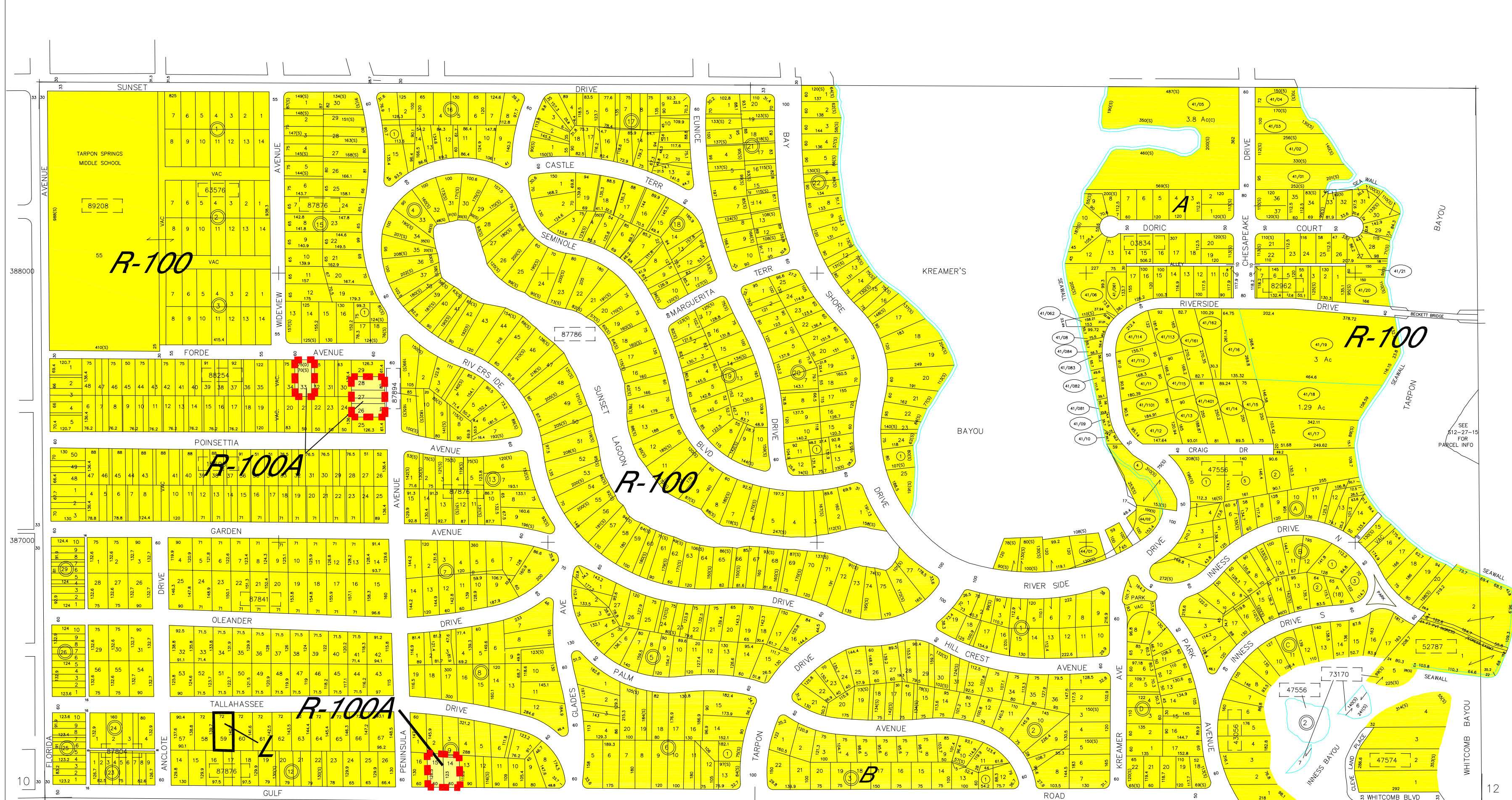

A: DORIC HOUSE 522 W. DORIC CT.  
14 CAPACITY  
B: SHADY GLENN II 1012 GULF RD.  
10 CAPACITY  
L: LICENSE TO ENCROACH (STORAGE SHED)  
(11/27/15/87841/000/0590)

NO.	NAME	PB/ PG	NO.	NAME	PB/ PG
03834	BAYOU GARDENS	13/026	87804	SUNSET HILLS 1ST ADD	10/027
15696	CLARK'S, H.L. SUB NO. 2 * LOTS 1 TO 50	11/081	87841	SUNSET HILLS 4TH ADD	65/016
43056	INNESS PARK	13/001	87876	SUNSET HILLS REPLAT * OF BLKS 10-12-13-14&15	07/069
47556	LAKE BUTLER VILLA CO'S SUB * OF SE 1/4 OF SE 1/4	D-P/824	87894	SUNSET HILLS REPLAT * OF BLK 14	24/072
47574	LAKE BUTLER VILLA CO'S SUB RESUB * OF BLK 5	10/051	88254	SUNSET VIEW * TARPON SPRINGS	19/035
52787	LONG YATES ESTATES	119/005	89208	TAMPA & TARPON SPRINGS LAND CO.	H1/116
63576	OAK TERRACE ADD * TO TARPON SPRINGS	15/003			
73170	PROSPECT POINT	H3/035			
82962	SMITH'S E.M. BAYOU SUB REV	21/063			
87786	SUNSET HILLS	07/038			

Produced by METI 101, Copyright (c) 1991-1992, Pinellas County, FL, Property Appraiser. All Rights Reserved.  
ATTENTION: Although this map file represents a geographically high degree of accuracy and completeness, it was prepared for use as a property assessment. Information on this document may be an aggregate of all data on file with the Property Appraiser's Office. It is not intended to be used for any other purpose. For more information, please contact the Property Appraiser's Office at 2750 Central Expressway, St. Petersburg, FL 33710. A professional land surveyor in any water involving property boundaries or rights of way.