

PROPERTY OWNERSHIP MAP  
PINELLAS COUNTY

PAM DUBOV  
PROPERTY APPRAISER

SCALE 1" = 300'  
DATE OF MAP: 04/10/80



COUNTY LOCATOR

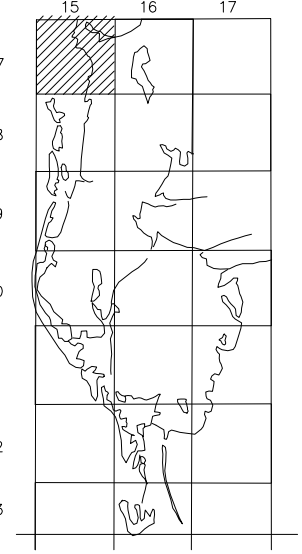

SHEET MATCH

N11-27-15	N12-27-15	N07-27-16
S11-27-15	S12-27-15	S07-27-16
N14-27-15	N13-27-15	N18-27-16

LEGEND

COUNTY LINE	---	AREA (FROM DEED)	10.5 Ac
CITY LIMIT LINE	---	AREA (CALCULATED)	10.5 Ac(c)
TAX DISTRICT LINE	---	DIMENSIONS (FROM DEED)	100.3
ROAD R/W	---	DIMENSIONS (SCALED)	1000.5
RAILROAD R/W	---	WATER	
SUB LINE	---	INTERSTATE HIGHWAY	(275)
PROPERTY LINE	---	U.S. HIGHWAY	(19)
LAND HOOK	---	STATE HIGHWAY	(60)
INTERIOR TRACT LINE OR ORIGINAL LOT LINE	---	COUNTY HIGHWAY	(1)
SUB LOT NUMBERS	---	ROADS OR STREETS	BY NAME
PARCEL NUMBER (N & S)	---	MAJOR TRANSMISSION LINES	POWER
BLOCK NUMBER	---		GAS OR OIL
STATE PLANE COORDINATES	---	SECTION CORNERS	2   1 11   12
		ASSIGNED M & B PINELLAS FARMS/GROVES GED-LOCATOR (BLK FIELD)	200   100 300   400
SUB NUMBER	---	OTHER ASSIGNED BLK/LOT DESIGNATOR	(3)

REVISIONS

DATE	BY	CHANGES OR ADDITIONS
09/05	YES	UPDATE/COMB
02/06	YES	UPDATE/COMB
01/06	YES	UPDATE/COMB
10/96	JD	REDO COORD./REDRAFT SECTION
10/96	MW	TRANSFORM SECTION TO 200 SCALE.

06/05 ORD. 2004-25  
SECTION S1/2 12  
TOWN 27 SOUTH-RANGE 15 EAST  
MAP NUMBER S12-27-15

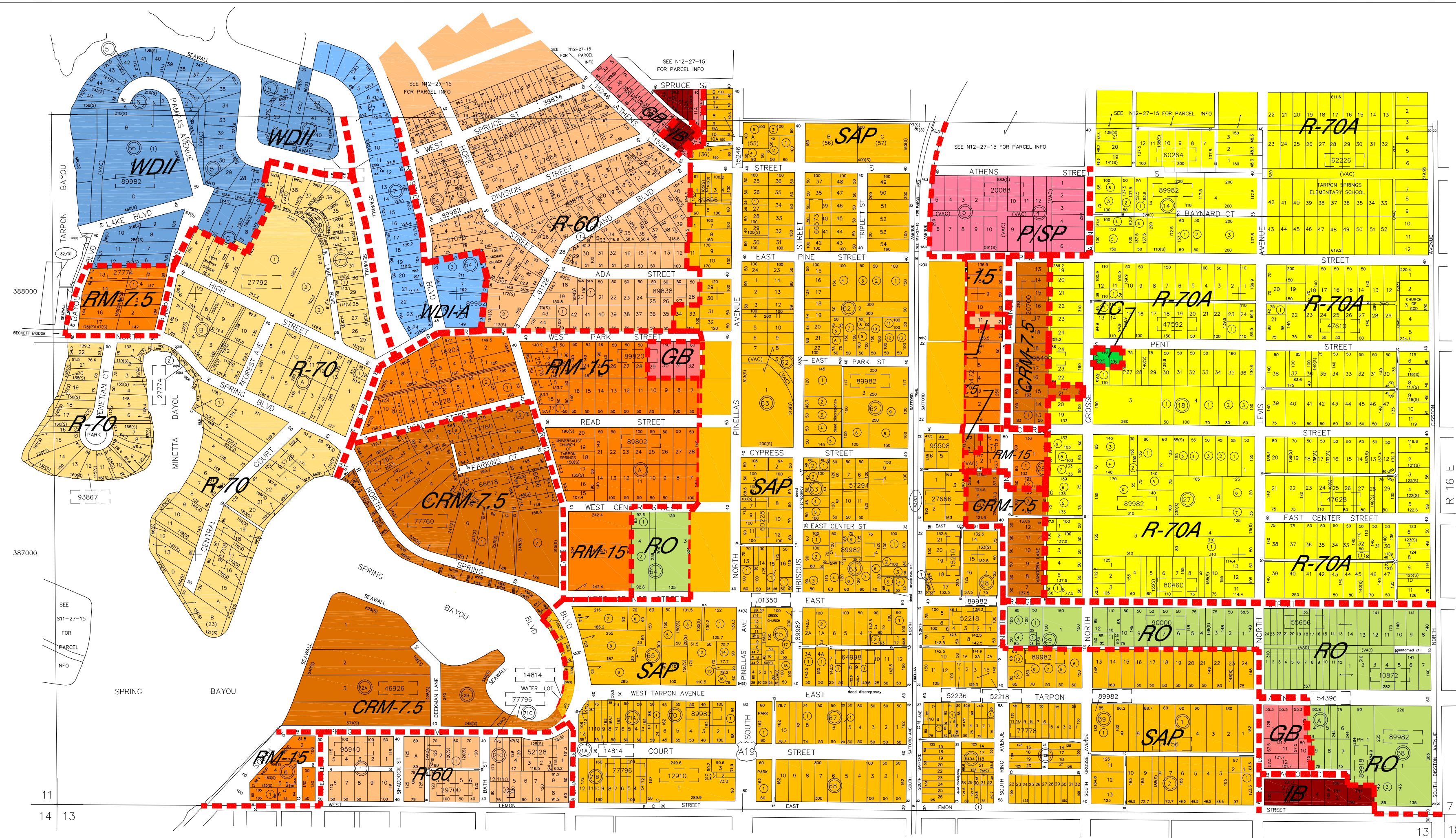

NOTE: SUB # 89982 DOES NOT FOLLOW STANDARDIZED PARCEL FORMAT  
LOT FIELD HAS BEEN SHIFTED TO LEFT 1 SPACE

NO.	NAME	PB/ PG	NO.	NAME	PB/ PG	NO.	NAME	PB/ PG	NO.	NAME	PB/ PG
01350	ARCADE SUB REVISED	08/003	27792	FERNALD'S, L.S. RESUB	04/036	62226	OAK DALE	12/059	89918	TARPON OAKS PROFESSIONAL CENTER CONDO	92/006
10872	BREEZE TERRACE	06/076	29700	FULFORD'S, P. W. RESUB	03/034	64998	OWNER'S DIVISION	19/077			
12910	BURRUSS SUB	107/029	39834	HILLCREST SUB	04/033	66573	PARKEN'S, MRS. S. SAFFORD	H1/099	89982	TARPON SPRINGS	D-G/800
14814	CHAPMAN, ALICE W., PROP. OF	10/032	46926	KNAPP'S SUB	H1/015	66618	PARKEN'S REV PLAT, MRS. S.B. OF LOT 1 BLK 60	03/026	90000	OFFICIAL MAP OF TARPON SPRINGS RESUB OF BLK 30	H4/008 H5/068
15210	CHEYNEY'S, J.K. SUB	H2/051	47592	LAKE BUTLER VILLA CO.'S SUB	H3/083		PARKEN'S RESUB	03/044	93708	VAN WINKLE'S SUB	09/075
15228	CHEYNEY'S, J.K. SUB	03/016	47610	LAKE BUTLER VILLA CO.'S SUB	H4/102	66636	SADLER, ADILE S. SUB	21/040	93726	VAN WINKLE REPLAT	24/052
15246	CHEYNEY'S MILL ADD	04/055	47628	LAKE BUTLER VILLA CO.'S SUB	H5/008	77724	SAFFORD'S, A. P.K.	H1/024	93867	VENETIAN COURT	08/027
15264	CHEYNEY'S MILL ADD REPLAT	18/003	52128	LINN'S, ALEXANDER SUB	05/006	77760	SAFFORD'S, A. P.K.	H1/014	94145	VILLA PLUMOSA CONDO	59/108
16902	COCORIS & ALEFANTIS SUB	21/073	52218	LITTLE GREECE	H5/017	77778	SAFFORD'S, A. P.K.	D-Q/054	95472	WEBSTER'S SUB	DP1/093
20088	CUPITT'S, T. C.	03/046	52236	LITTLE GREECE RESUB	04/059	77796	SAFFORD'S, A. P.K.	12/062	95490	WEBSTER'S SUB	03/029
20700	DE GOLIERS	H3/070	53352	LUTEAN SHORES	20/044	80460	SHAW SUB	H4/047	95508	WEBSTER'S SUB, MRS. C.D.	04/029
21078	DIAMANDIS, JOHN SUB	21/036	54396	MAGNOLIA HEIGHTS	16/063	89802	TARPON HEIGHTS SEC A	H4/047	95940	WELSH'S BAYOU ADD	03/021
25776	EMANUEL'S, GEORGE RESUB	03/029	55656	MARTIN'S SUB	H1/040	89820	TARPON HEIGHTS SEC B	H4/047			
27666	FERGUSON'S SUB	21/030	57294	MERE'S SUB	D-G/558	89838	TARPON HEIGHTS SEC C	03/042			
27684	FERGUSON'S 'c'	01/011	60228	NOBLITT'S, G.E.	H3/027	89856	TARPON HEIGHTS SEC C REPLAT	01/032			
27756	FERNALD'S, L.S.	H4/100	60264	NOBLITT & DECKER'S SUB	H6/022	89874	TARPON HEIGHTS, REV PLAT OF SECTION D OF I.B. READS	01/033			
27774	FERNALD'S, L.S.	H3/003	61128	NORTHRUP, CLARK	10/059						